

The Need For Every
Process Industry



**INDUSTRIAL
BIMETAL
THERMOMETER**

MODEL : SC / T - 501

TEMPERATURE

INDUSTRIAL BIMETAL THERMOMETER

MODEL : SC / T - 501

General Purpose



FEATURES

- ✓ Bimetal helix system
- ✓ Hermetically sealed
- ✓ Stem length max 1.5 Mtr
- ✓ Optional External Zero adjustment

APPLICATION

- ✓ Liquid & gaseous mediums
- ✓ Corrosive environments
- ✓ Oil & Gas applications
- ✓ Chemical & Petrochemical
- ✓ Food & Beverages
- ✓ Nuclear power plants

STANDARD PARAMETERS

Accuracy	: CL 1.0 (Class 1)
Ambient temperature	: -20... +60°C
Over range limits	: 110% full scale
Stem pressure rating	: 25 bar (Without thermowell)
Weld joints	: TIG argon arc welding

MATERIAL OF CONSTRUCTION

Sensing element	: Coiled bimetal strip
Case & Ring material	: AISI 304 SS
Stem & Process connection material	: AISI 316 SS
Dial	: Aluminum, black graduation on white background
Pointer	: Slotted zero adjustable, aluminum, black powder coated (Fix pointer for DN50)
Gaskets	: Neoprene
Window	: Sheet glass

STANDARD SPECIFICATIONS

Dial size	: Dn100
Range	: 0...100°C
Mounting pattern	: Direct Bottom connection
Stem size	: 6.0 mm
Ingress protection	: IP 65
Stem length	: 150 mm
Process connection type	: Adjustable connection
Process connection	: 1/2" NPT (M)

STANDARD SPECIFICATIONS : DAMPENING LIQUID FILLED, GLYCERIN

Gaskets & Filling plugs	: Neoprene
Dampening liquids	: Glycerin 99.7% (-20°C to 65°C) [Up to range 100°C]
Window	: Shatterproof safety glass

STANDARD SPECIFICATIONS : DAMPENING LIQUID FILLED, SILICON

Gaskets & Filling plugs	: NBR
Dampening liquids	: Silicon 99.7% [Up to range 200°C]
Window	: Shatterproof safety glass

DIMENSIONAL DRAWING

Mounting Pattern: B0

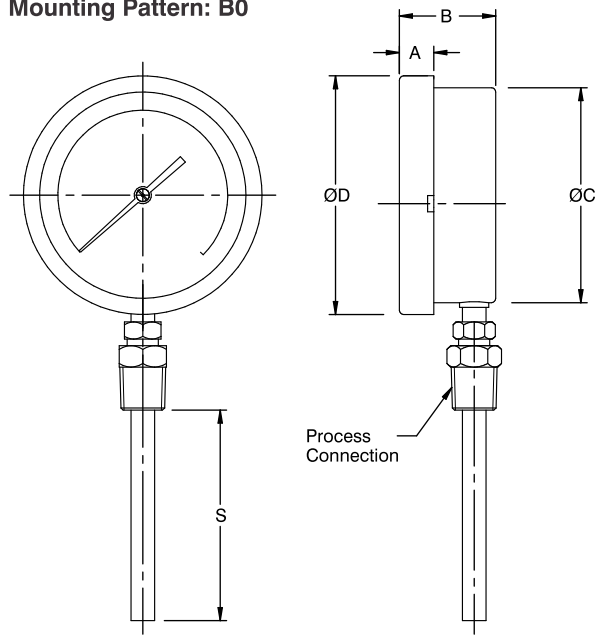

NS	A	B	ØC	ØD	S
63	12	48	62.5	70	*
80	9.5	48	80	89.5	*
100	12	48	100	111	*
125	15	48	118.5	129	*
150	15	48	149	161	*

* As per customer requirement.

Mounting Pattern: R0

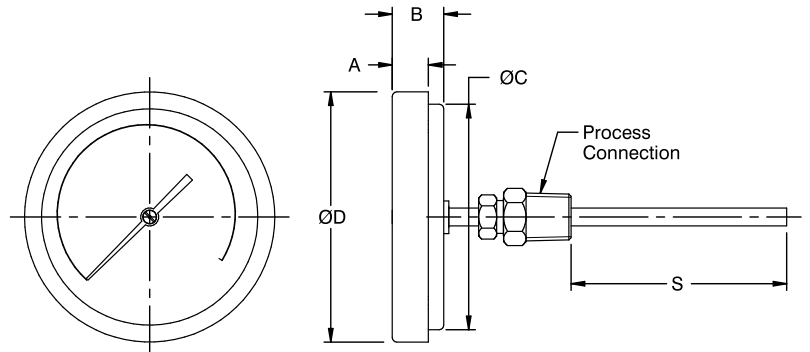

NS	A	B	ØC	ØD	S	Weight (grams)
50	6.5	23	51.5	57.5	*	
63	10	23	62.5	70	*	156
80	9.5	23	80	89.5	*	244
100	12	23	100	111	*	518
125	15	23	118.5	129	*	
150	15	23	149	161	*	

* As per customer requirement.

All dimensions are in mm.

RANGE TABLE

RANGE	" °C "	RANGE	" °C "	RANGE	" °C "
-20...+40	C01	0...50	C13	0...200	C20
-20...+60	C02	0...60	C14	0...250	C21
-30...+70	C08	0...80	C15	0...300	C22
-30...+120	C05	0...100	C16	0...400	C23
		0...120	C17	0...500	C24
		0...150	C18	0...600	C25

NOTES

- For other connections, please contact factory.
- DN50 is available in Centre back connection (R0) only.
- Equivalent scales available in °F, °C/°F, °F/°C. Please contact factory for details.

ORDERING CODES

1. DIAL SIZE

02	50 mm / 2"
25	63 mm / 2½"
03	80 mm / 3"
04	100 mm / 4"
05	125 mm / 4½"
06	150 mm / 6"

04

2. RANGE

XXX Refer "Range Table"

C16

3. MOUNTING PATTERN

B0 Direct, Bottom connection
R0 Centre, Back connection

B0

4. STEM DIAMETER

M60 6.0 mm
I14 ¼" (6.35 mm)
M80 8.0 mm
M95 9.5 mm
M10 10 mm
M12 12 mm

M60

5. INGRESS PROTECTION

ER IP 65
ES IP 66
ET IP 67
EU Hermetically sealed

ER

6. STEM LENGTH

XXXX Up to 1,500 mm

150

7. PROCESS CONNECTION TYPE

KX Fixed connection
KW Adjustable connection
BW Swivel / Revolving connection

KW

8. PROCESS CONNECTION

14N ½" NPT (M)
14B ½" BSP (M)
12N ¼" NPT (M)³
12B ¼" BSP (M)³
14M M20 X 1.5 mm (M)
13B 3/8" BSP (M)⁴
T15 1.5" Triclover
15N ¾" NPT (M)
15B ¾" BSP (M)

14N

9. OTHER OPTIONS

BA Case & Ring in AISI 316 SS (B0)
BG Case & Ring in AISI 316 SS (R0)
GC Shatterproof safety glass
GZ External zero adjustment
OA Dampening liquid, silicon oil (200°C)
OL Dampening liquid, silicon oil (350°C)
RA Rubber parts, Viton
RN Rubber parts, NBR
TA 5 - point factory calibration certificate
TM Material test certificate 2.2
XF SS tag plate, AISI 304 SS
XG SS tag plate, AISI 316 SS
XT Dial tag marking
XR Custom designed dial
EG Dampening liquid, glycerin (65°C)

XX

Ordering Example : T501-04-C16-B0-M60-ER-150-KW-14N

NOTES

- For other connections, please contact factory.
- DN50 is available in Centre back connection (R0) only.
- 1/4" connections are available up to 1/4" (6.35 mm) stem diameter only.
- 3/8" connections are available up to 10 mm stem diameter only.



Head Office

303, SIDDHARTH TOWER, G.P. PAI ROAD, KOPRI, THANE (E) - 400603 MAHARASHTRA, INDIA
 Phone : +91 22 2532 8223
 +91 22 2532 8224
 Email : info@spinkcontrolsindia.com

Plant 1

GALA No. F-4 A WING, UDYOG BHAVAN-2 ADDITIONAL AMBERNATH, INDUSTRIAL AREA, ANAND NAGAR MIDC AMBERNATH, THANE 421501
 Phone : +91 9594991196
 Email : rupa.thakkar@spinkcontrols.com

Plant 2

PLOT No.: MS 114/115, AMBERNATH INDUSTRIAL AREA, CHIKHLOLI MIDC, AMBERNATH (W) THANE 421501
 Phone : +91 7400159593
 Email : avanti.rangdal@spinkcontrols.com

